



# PED-Basic

For Downloading Embroidery Designs



For all Brother Home Embroidery Machines

At your side.  
**brother**®

# PED-Basic

For Downloading Embroidery Designs

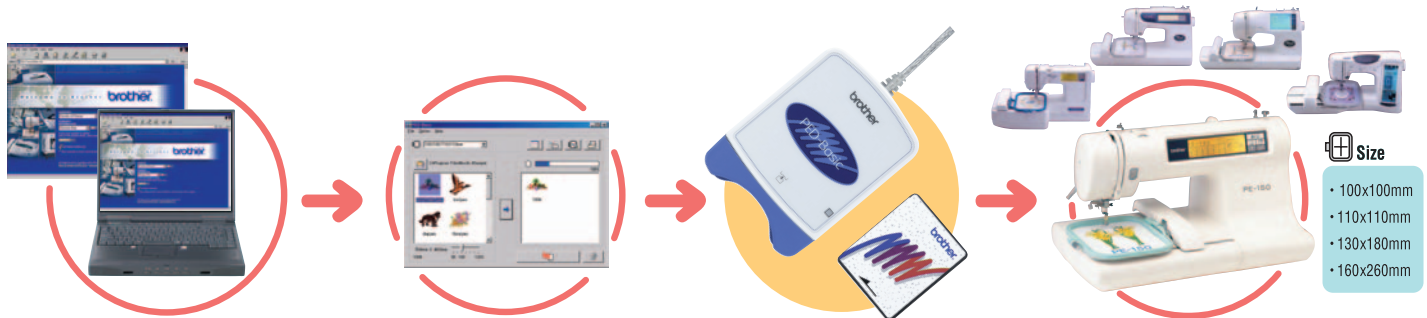

Using your computer and the PED-Basic software, you can download PES embroidery data from the Brother Web site ([www.brother.com](http://www.brother.com)) or from any other embroidery data distribution site.

Imported embroidery data can be previewed or edited on the screen.

Write the PES data to an original Brother embroidery card.

Next, simply insert the card into a Brother embroidery machine and press the Start button to sew beautiful embroidery.

\* This product cannot be used to create embroidery data.

## ● PES format

Embroidery data (\*.pes files) created with the Brother design software PE-DESIGN can be purchased or downloaded from the Internet.

## ● Built-in Embroidery Samples



## ● Simple previewing and editing of embroidery data

- **Sizing**  
The size can be changed within a range of 90% to 120%, on selected designs.
- **Realistic preview**  
The stitching can be reproduced on the computer screen so that the actual embroidery can be previewed.
- **Printing**  
The embroidery pattern information (pattern name, size, number of stitches, and thread colors) can be printed. Organizational tool and convenient for making design templates.

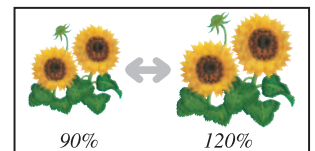

### Package Includes

1. CD-ROM program file
2. 4M blank memory card
3. USB Card Writer Box
4. Instruction Manual

### PC REQUIREMENT

Computer	IBM PC or compatible (DOS/V) computer originally equipped with a USB port
Operating system	Windows 98, ME, XP or 2000
Processor	Pentium 133 MHz or higher
Memory	Minimum 32 MB (64 MB or more is recommended)
Hard disk free space	Minimum 10 MB
Monitor	SVGA (800 × 600), 16 bit color or higher
Port	USB Ver. 1.1
Printer	Printer supported by your system (for printing pattern information)
CD-ROM drive	Required for installation

Windows® is a registered trademark of Microsoft Corporation in the US and/or other countries. All other brand and product names are registered trademarks or trademarks of their respective companies.

**SPECIFICATIONS ARE SUBJECT TO CHANGE WITHOUT NOTICE.**

At your side.  
**brother**®

Brother International (Aust) Pty Ltd

Corporate Web-site: [www.brother.com.au](http://www.brother.com.au)

NSW/ACT: 7 Khartoum Rd. North Ryde NSW 2113 Phone: (02) 9887 4344 Fax: (02) 9870 7234

VIC: 43 Carrington Rd. Box Hill VIC 3128 Phone: (03) 9899 4844 Fax: (03) 9899 4833

QLD/NT: Unit 4, 57 Miller St. Murrarie QLD 4172 Phone: (07) 3348 9266 Fax: (07) 3348 9366

SA/TAS: Unit 4, 13 King William Rd. Unley SA 5061 Phone: (08) 8272 1300 Fax: (08) 8272 1199

WA: 117 Great Eastern Highway, Belmont WA 6104 Phone: (08) 9478 1955 Fax: (08) 9277 2177

All specifications subject to change without notice